

# VORTEX

TOY HAULERS





Convection Microwave Oven

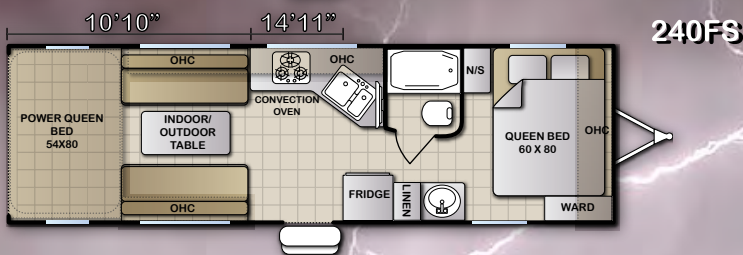
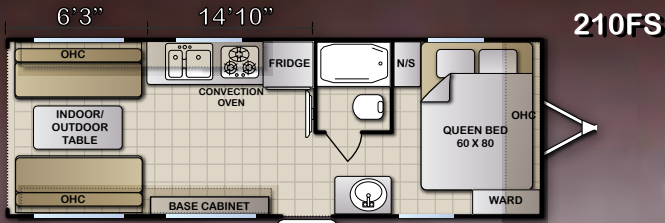

Doorside Flood Light w/ Dimmer

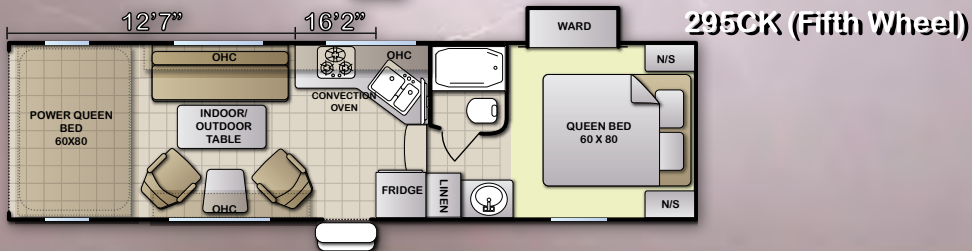

AM/FM/CD/DVD w/ MP3 Input

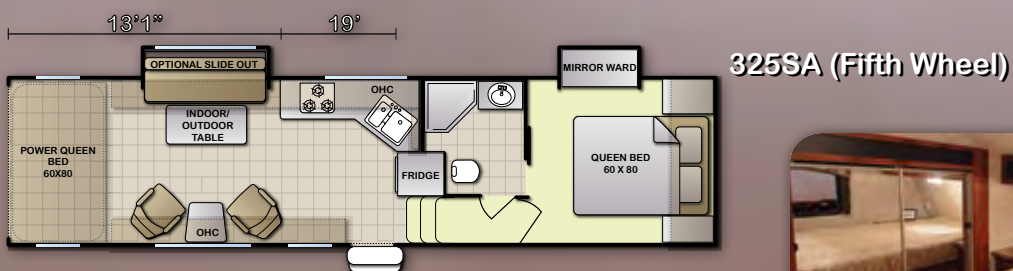

295CK Bedroom with island queen bed and mirror wardrobe slide out





The 270FS shown in Saddle decor with dual swivel chairs and dual electric bed with optional lower jack knife sofa.



Black Tank Flush



40 Gallon Fueling Station

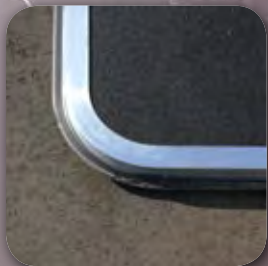

Radius Ramp Door

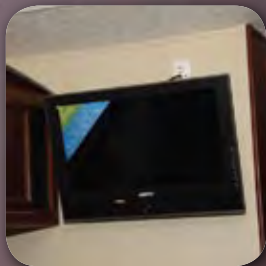

19" or 26" LCD TV



4.0k Built-In Onan Generator



Marine Grade Exterior Speakers



High-Pressure Wash Down Kit

## SPECIFICATIONS

MODEL	FLOOR LENGTH*	OVERALL WIDTH	OVERALL HEIGHT**	GVWR	DRY WEIGHT	HITCH WEIGHT	CCC***	FRESH WATER	GRAY/BLACK
200FB	22'7"	96"	11'4"	9,000 lbs	6,340 lbs	1,160 lbs	2,660 lbs	100gal	40/40gal
210FS	22'11"	96"	11'4"	9,000 lbs	5,870 lbs	870 lbs	3,130 lbs	100gal	40/40gal
240FS	25'11"	96"	11'4"	9,990 lbs	6,520 lbs	1,210 lbs	3,470 lbs	100gal	40/40gal
270FS	28'3"	96"	11'4"	9,990 lbs	6,740 lbs	1,120 lbs	3,250 lbs	100gal	40/40gal
295CK	30'4"	96"	12'9"	12,200 lbs	8,120 lbs	1,920 lbs	3,990 lbs	100gal	40/40gal
325SA	34'7"	102"	13'5"	15,500 lbs	TBD	TBD	TBD	160gal	50/50gal

\*Add approximately 3'8" for overall length

\*\*From ground to top of A/C

\*\*\*Weight of water, LP gas and options are not included in Payload.

## EXTERIOR FEATURES

- "ONAN" 4.0k BUILT-IN GENERATOR
- CHROME WHEELS
- AWNING
- BLACK TANK FLUSH
- ALUMINUM WALL LAMINATED CONSTRUCTION
- DIAMOND PLATE EXTERIOR (FRONT AND SIDES)
- HIGH INTENSITY DOOR SIDE LIGHT W/ DIMMER SWITCH
- HIGH INTENSITY REAR LIGHTS
- ONE-PIECE RUBBER ROOF
- 12 VOLT HITCH LIGHT
- SEWER HOSE COMPARTMENT
- KEYED RAMP DOOR CAM LOCKS
- 7' RADIUS RAMP DOOR W/ EZ LIFT SPRINGS
- 8' RAMP DOOR ON 325SA
- SPARE TIRE & CARRIER
- STABILIZER JACKS (4)
- DARK TINTED GLASS WINDOWS
- WHITE POWDER-COATED BUMPER AND DOOR FRAME
- ULTRA LUBE AXLES
- WASH DOWN KIT W/ PRESSURE WASHER
- 40 GALLON DOORSIDE FUELING STATION
- DUAL 7-1/2 GALLON LP TANKS W/ UPGRADED COVER (TT'S)
- "DOMETIC" 13.5 BTU AIR CONDITIONING
- 6 GALLON GAS WATER HEATER W/ DSI
- TV ANTENNA
- "JENSEN" MARINE GRADE EXTERIOR SPEAKERS
- WATER HEATER BY-PASS
- UNDER AWNING CABLE TV HOOK-UPS
- CABLE TV HOOK-UPS
- RADIUS AUTOMOLD



295CK Shown in Mocha decor

## INTERIOR FEATURES

- EXCLUSIVE CRAFTSMAN CHERRY CABINETS
- MASTER CONTROL PANEL
- CURVED WALLS (PER FLOOR PLAN)
- FULLY COVERED FLOOR W/ "ARMSTORNG" LINOLEUM
- STEEL FRAMED FOLD-UP SOFA'S
- MINI-BLINDS THROUGHOUT
- 3 BURNER COOK TOP
- FLUSH MOUNT TIE-DOWNS
- MICROWAVE/CONVECTION OVEN
- 6 CU. FT. "DOMETIC" REFRIGERATOR
- LAMINATE COUNTERTOPS W/ LAMINATE EDGING
- CENTRAL DUCTED A/C (FRONT BEDROOM MODELS)
- ACRYLIC DOUBLE BOWL SINK
- DELUXE FAUCET WITH PULL OUT SPRAYER
- DUAL ELECTRIC POWER BED (PER FLOOR PLAN)
- FULL LENGTH BALL BEARING DRAWER GLIDES
- "JENSEN" AM/FM/CD W/ DVD PLAYER
- 19" OR 26" "JENSEN" LCD TV IN LIVING ROOM (PER FLOOR PLAN)
- PORCELAIN FOOT PEDAL FLUSH TOILET
- BATH TUB W/ SKYLIGHT
- DECKED FLOOR W/ FULL R-8 FIBERGLASS INSULATION
- RESIDENTIAL SIZE 60" X 80" QUEEN BED

## OPTIONS

- REAR SCREEN WALL
- 2ND A/C IN BEDROOM- 13.5 W/ THERMOSTAT (PER FLOORPLAN)
- 8 CU.FT. DOUBLE DOOR REFER (PER FLOORPLAN)
- CARPET KIT
- 15K HIGH OUTPUT A/C IPO 13.5K
- DOUBLE ROOF INSULATION
- NIGHT SHADES
- GENERATOR 5.5KW (IPO 4KW) /50AMP SERVICE (325SA ONLY)
- SOFA IPO LOWER BUNK (PER FLOORPLAN)
- TOY LOCK
- TV-19" LCD W/DVD BEDROOM
- POWER AWNING
- THERMAL PANE WINDOWS
- SLIDE-OUT SOFA (PER FLOORPLAN)
- ENCLOSED UNDERBELLY
- ALUMINUM WHEELS

## DEALER INFO



**MVP RV**  
5300 VIA RICARDO  
RIVERSIDE, CA 92509  
(951) 848 4288

[WWW.MVPRV.COM](http://WWW.MVPRV.COM)

\*All items subject to change without notice